

Mini floating holders with side lock holder

Product information

- holder shank with lateral clamping surface
- suitable for conventional and high performance multi-fluted reamers, because of no angle compensation
- very compact design for restricted space
- central coolant supply max. 80 bar
- drive flat on tool shank necessary
- for tool shank tolerance h6

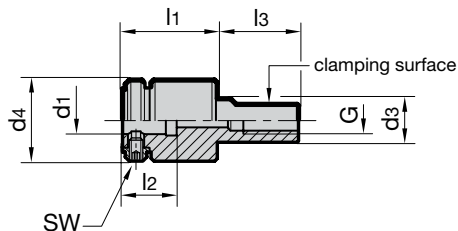

Scope of delivery

- for other shank \varnothing order reduction sleeves Guhring no. 4097 separately
- order hexagon chuck key Guhring no. 4912 separately
- further sizes with differing radial play are available on request



Series Number **4174**

d_3 g6 mm	for holder $d_{1,h6}$ mm	recommended tool- \varnothing	d_4 mm	l_1 mm	l_2 mm	l_3 mm	G	SW	radial play	Order Code	EDP Numbers
16	10	to \varnothing 14	30	35	20	30	1/8	2.5	0.12	10.016	9041740100160

Floating holder with ER collet holder

Product information

- straight shank d_3 with whistle notch flat
- suitable for conventional and high performance multi-fluted reamers, because of no angle compensation
- for the application of internally cooled reamers use metallic sealed collets type DM Guhring no. 4175
- central coolant supply max. 80 bar

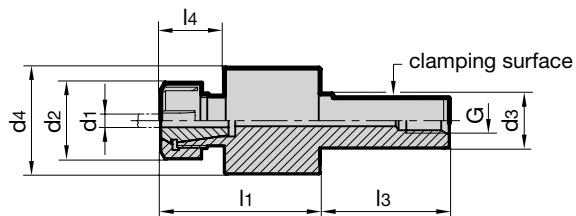

Scope of delivery

- incl. retaining nut
- order collet Guhring no. 4175 or 4307 as well as clamping key Guhring no. 4913 separately
- further sizes with differing radial play are available on request



Series Number **4098**

d_3 g6 mm	recommended tool- \varnothing d1 mm	clamping range	d_2 mm	d_4 mm	l_1 mm	l_3 mm	l_4 mm	G	radial play	Order Code	EDP Numbers
16	bis \varnothing 16	ER20 \varnothing 1-13	34	49.5	74	40	29.5	1/8	0.06	20.016	9040980200160
20	\varnothing 4 - \varnothing 24	ER25 \varnothing 2-16	42	59	84	50	35	1/8	0.06	25.020	9040980250200
25	bis \varnothing 16	ER20 \varnothing 1-13	34	49.5	74	60	29.5	1/4	0.08	20.025	9040980200250
25	\varnothing 4 - \varnothing 24	ER25 \varnothing 2-16	42	59	84	60	35	1/4	0.08	25.025	9040980250250
32	\varnothing 6 - \varnothing 30	ER32 \varnothing 3-20	50	64	91	80	35.5	3/8	0.10	32.032	9040980320320
40	\varnothing 6 - \varnothing 30	ER32 \varnothing 3-20	50	64	91	80	35.5	1/2	0.12	32.040	9040980320400